

FLUSHING RING FOR DIAPHRAGM SEAL -FLANGE TYPE

SSKE30-6

APPLICATIONS

- Max. Working Temperature 300° C Max.
- Working Pressure as per Flange Rating
- Flushing the diaphragm -viscous /semisolid Liquid
- Low and High Pressure applications

FEATURES

- MOC-SS16 /MONEL
- Flushing Port- 1 /2 nos
- Suitable for all facing -RF /RTJ,,,

SSKE™



FLUSHING RING - SSKE30-6

DESCRIPTION

General

Thread design : ANSI B1.20.1 / BS EN ISO 228-1

Service temperature : 300° C

Working Pressure : As per Flange Rating

Material of construction

Ring Material : AISI 316 SS / MONEL

Standard version

Porting connection : ½" NPT (F) / 1/4" NPT (F)

Suit to Flange : All Standard Flange

Suit to Facing : RF /RTJ

GA DRAWING

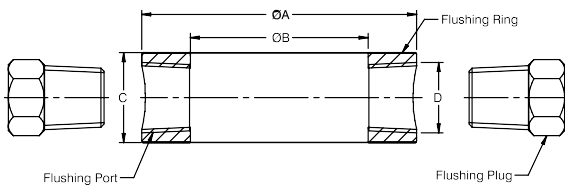

Flange Size	Class	A	B	C	D
½"	150 # to 600 #	35	20	30	¼" NPT or ½" NPT (F)
¾"	150 # to 600 #	43	26	30	
1"	150 # to 600 #	51	32.5	30	
1½"	150 # to 600 #	73	47.5	30	
2"	150 # to 600 #	92	59.5	30	
2½"	150 # to 600 #	105	72.5	30	
3"	150 # to 600 #	127	88	30	

ORDERING CODES

MODEL SSKE30-6 - Flushing Ring

SSKE30-6

FLUSHING TYPE

G1

RF Type

G3

RTJ Type

G1

BODY MATERIAL

S02

AISI 316 SS

S05

MONEL

S02

PORT CONNECTION

P28

1/2" NPT (F)

P27

1/4" NPT (F)

P27

PLUG CONNECTION

P08

½" NPT (M)

P07

½" BSP (M)

P07

OPTIONS

E86 Tested to NACE standards

E31 Material test certificate 3.1

E32

Material test certificate 2.2

E86

Ordering Example : SSKE30-6.S02.P27.P07.E86/XX.

SHREE SAMARTH KRUPA ENGINEERS

Contact : +91 8155865961, +919586682557

prakash@shree-samarthkrupa.com, www.shree-samarthkrupa.com